

## LOW-VOLTAGE UNDERWATERLIGHT 4.0088

### Specifications

Rated voltage:	350 mA
Rated power:	1 W
Current connection:	WIBRE 5.0635.00.03
Installation depth:	Maximum 3 m

**With built-in high-limit thermostat with automatic reset function.**

### Important

The underwater light may be used only in connection with a level sensor which ensures that the light cannot be switched on unless the front of the lamp is under water. The underwater light requires external potential equalization.

### Installation

1. Drill a 36 mm hole in the tub.
2. Fix the sealing o-ring (14) and add, if necessary, silicone. Pass the body (01) through the hole from the inside of the tub.
3. Place the gasket (13) (from backside) around the body (01).
4. Fix the nut (11) from backside and fasten it tightly on the body (01).
5. Fix the nut (11) to the body (01) with the pointed screw (12a).
6. Fix the lamp (01) to the tub with the pointed screw (12b).
7. Fasten the P.G. screw (14) to the body (01).
8. Place the bulb (03) in the ceramic socket (02) and push it into the body (01).
9. Place the o-ring (04) in front of the bulb (03) and place the frontglass (05) on top of it. Hold the frontglass (05) while screwing the escutcheon (07) carefully on to the body (01).
10. Fix the escutcheon (07) to the lamp (01) with the pointed screw (06).
11. Connect the cable (16) to the low-voltage side of the safety transformer.
12. Carry out external potential equalization via the bolt (10) on the nut (11).

### Replacement of low-voltage halogen bulb

This may be done only when the tub is empty.

1. Loosen the pointed screw (06) that fixes the front (07) to the lamp (01).
2. Unscrew the front (07), and remove the front glass (05) and the o-ring (04).
3. Pull the bulb (03) out of the light body (01), and carefully remove it from the ceramic socket (02).
4. Place a new bulb (03) in the ceramic socket (02), and push it back into the lamp housing (01).
5. Place a **new o-ring** (04) in the recess, position the front glass (05) in the right place, and hold it in place while fastening the front (07).

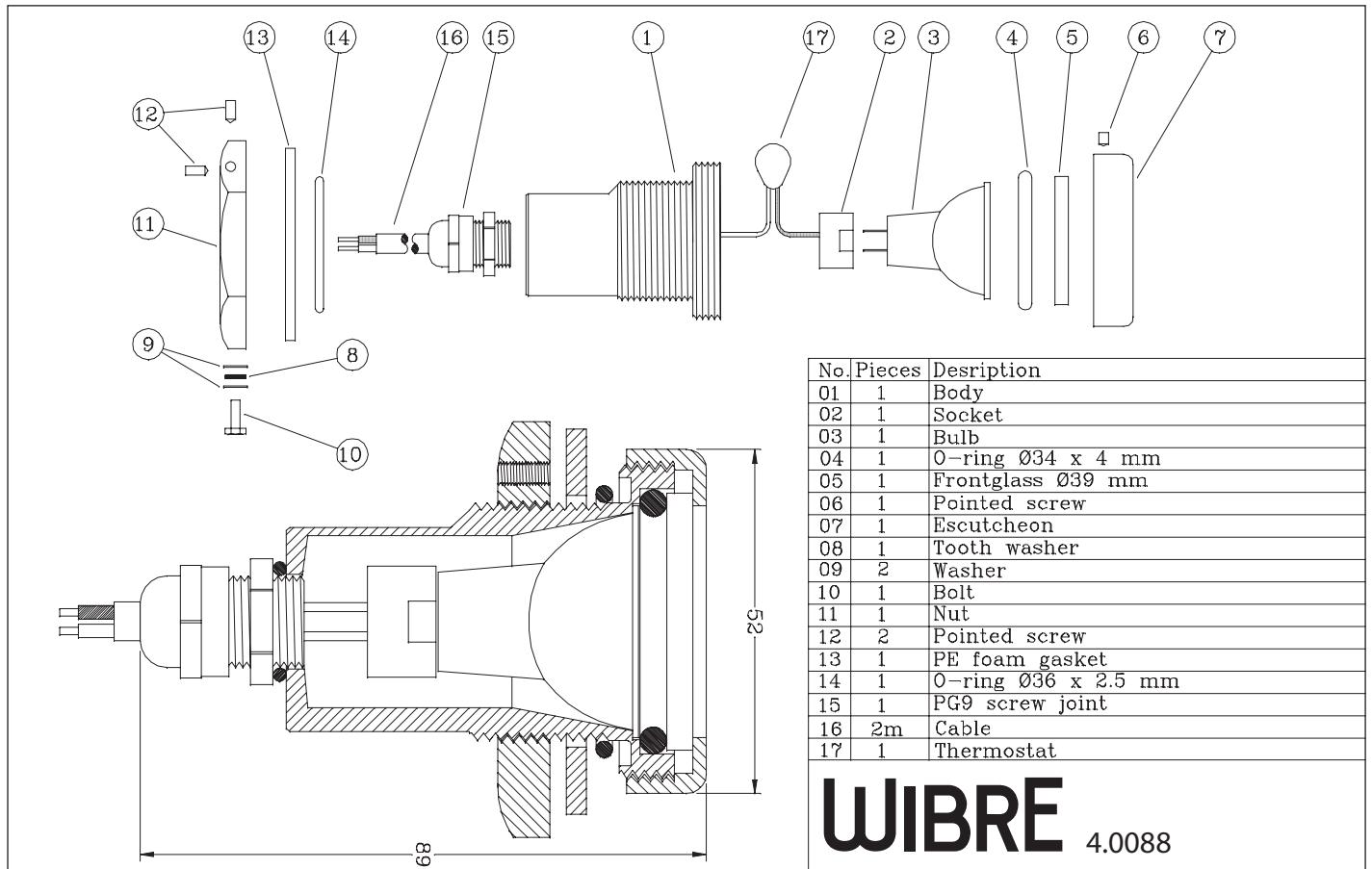

# WIBRE

 4.0088